

Ground Floor

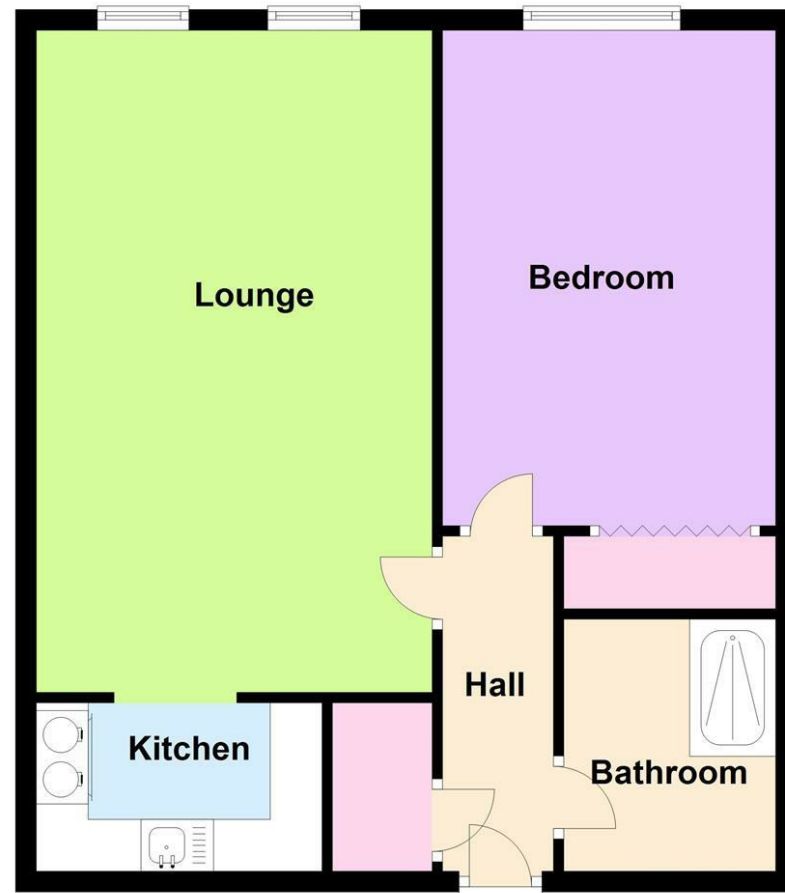

**Homeregal House Bellingham Lane  
Rayleigh, SS6 7HN  
£175,000**

- Purpose Build For Over 55's
- 1 Bedroom 1st Floor Apartment
- House Manager & Care Line System
- Spacious Lounge
- Modern Kitchen & Shower Room
- Bedroom With Fitted Wardrobes
- Communal Parking & Landscaped Gardens
- Just Off Rayleigh High Street
- Early Viewing Recommended
- No Onward Chain



12-14 Berrys Arcade  
High Street  
Rayleigh  
SS6 7EF

Tel: 01268 770728  
info@stgeorgehomes.co.uk  
www.stgeorgehomes.co.uk

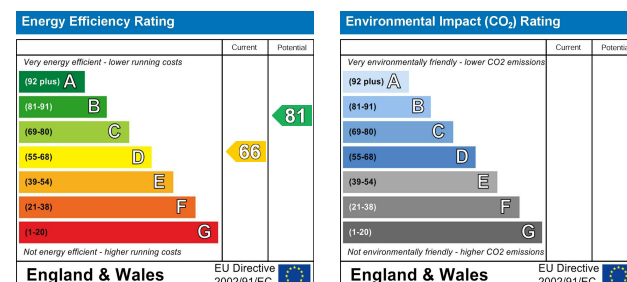



**SOUGHT-AFTER DEVELOPMENT FOR THE OVER 55s – JUST OFF RAYLEIGH HIGH STREET**

We are pleased to offer this spacious one-bedroom first floor apartment, located within a highly regarded retirement development just a short walk from Rayleigh High Street.

The property features:

- A bright and airy lounge
- Well-maintained kitchen and shower room
- Electric heating and double glazing throughout

Residents benefit from a welcoming community and a range of excellent shared facilities, including:

- Two comfortable communal lounges
- A convenient laundry room
- On-site House Manager for additional support
- Landscaped rear gardens – a peaceful spot to enjoy sunny days

Perfectly positioned just off Rayleigh High Street, the development offers easy access to local shops, cafés, restaurants, and public transport links — ideal for enjoying an independent lifestyle with support when needed.

**ACCOMMODATION**

Communal door with entryphone system leading to entrance hall providing access to the house manager's office & complex lounges, stairs & lift leading to the first floor,

**HALL**

Large storage cupboard, care line system, power point, coving,

**LOUNGE 19'3 x 10'3 (5.87m x 3.12m)**

Two double glazed windows to front, storage heater, assistance cord, entry phone, coving, wall light points, power & Tv points, storage heater,

**KITCHEN 10'3 x 5'3 (3.12m x 1.60m)**

Recently fitted with a modern range of white eye level & base level units with complimentary work tops, stainless steel sink drainer, twin electric hob, coving, power points,

**BEDROOM 1 14'3 x 8'8 (4.34m x 2.64m)**

Double glazed window to front, fitted wardrobe to recess area, storage heater, wall lights, power & Tv points,

**SHOWER ROOM**

Modern white suite comprising large shower with glazed surround, vanity wash hand basin having storage cupboards below, low level wc, extractor fan, wall heater & heated towel rail, assistance cord,

**OUTSIDE**

**GARDENS**

Within the grounds are delightful landscaped gardens with seating, lawn area's and evergreen shrub beds

**PARKING**

To the rear is private parking (not allocated)